



# FLEXIBLE BATTERY CARE

M100 is a smart and flexible 12V battery charger and one of the newest members in CTEKs new Marine line. It satisfies the need of battery care in the marine environment for 14-225Ah batteries and even AGM batteries. M100 has a special Recond mode which can recover a stratified battery and therefore give the battery a longer life. This is perfect for the rough condition of the marine environment as boat batteries often becomes deeply discharged causing stratification. The Supply function is used as a power source. M100 delivers 7A, is IP65 classed and follows the CTEK criteria: both charges and maintains, no harmful galvanic currents, reverse polarity protected, spark-free, rain and splash proof, electrical equipment will not be damaged and has a 5 year warranty.

## TECHNICAL DATA

INPUT VOLTAGE	220-240VAC, 50-60Hz
CHARGING VOLTAGE	14.4/14.7/13.6V/15.8
CHARGING CURRENT	7A max
COOLING	Natural convection
RIPPLE	<4%
AMBIENT TEMPERATURE	-20°C to +50°C
TYPE OF CHARGER	8-step, fully automatic charging cycle
TYPE OF BATTERY	All types of 12V lead-acid batteries
BATTERY CAPACITY	14-150Ah, maintenance 14-225Ah
PROTECTION CLASS	IP65 (splash & dust proof)
DIMENSIONS	191x89x48mm
WEIGHT	0.8kg



Fully automatic for optimal charging



For all lead-acid batteries



**FULLY CHARGED BATTERY MAINTENANCE CHARGING**



For charging in cold conditions and AGM batteries



Recondition of deeply discharged batteries



Use the charger as a power supply



No harmful galvanic currents



THE SMARTEST BATTERY CHARGERS IN THE WORLD

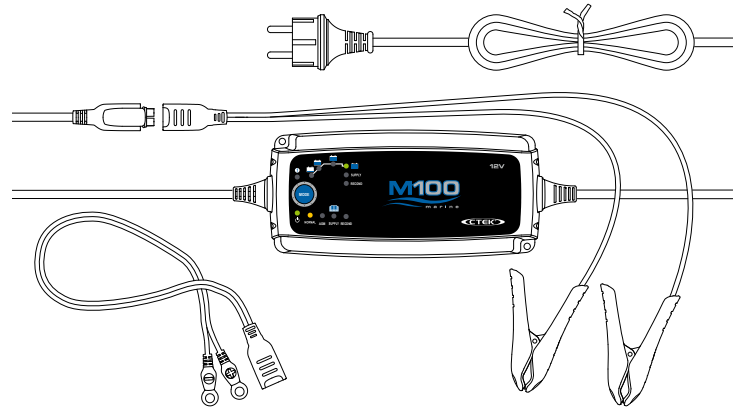

**CTEK CHARGING**

	DESULPHATION SOFT START
	BULK
	ABSORPTION, <b>READY TO USE</b> ANALYSE
	FLOAT, <b>FULLY CHARGED</b> PULSE, <b>MAINTENANCE CHARGING</b>
<b>SUPPLY</b>	SUPPLY
<b>RECOND</b>	RECOND

- Fully automatic charging and maintenance in 8 steps maximizes battery life and performance
- Numerous accessories simplifies using the same charger for multiple batteries
- Water-resistant
- Power Supply that simplifies battery replacement without losing vehicle memory
- Patented maintenance charge for a unique combination of maximized life and performance
- Recondition of deep discharged batteries
- Patented desulphation that extends the battery life
- No sparks, short-circuit proof and reverse-polarity protected for untroubled usage
- Automatic detection of end-of-life batteries that eliminates surprises

**PROGRAMS**

<b>NORMAL</b>	7A/14.4V
<b>AGM</b>	7A/14.7V
<b>SUPPLY</b>	7A/13.6V
<b>RECOND</b>	1.5A/15.8V

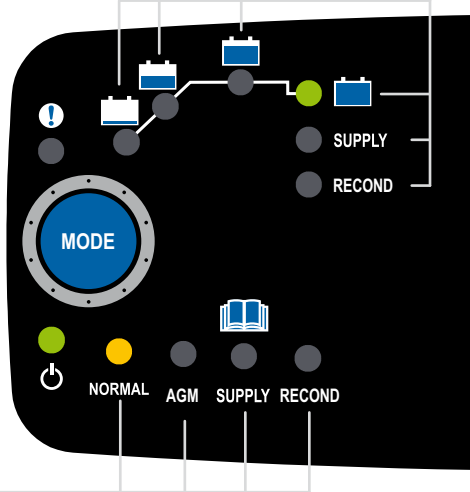

**CONNECT AND CHARGE**

- 1 CONNECT THE CHARGER TO THE BATTERY
- 2 CONNECT THE CHARGER TO THE WALL SOCKET
- 3 PRESS THE MODE-BUTTON TO SELECT CHARGING PROGRAM

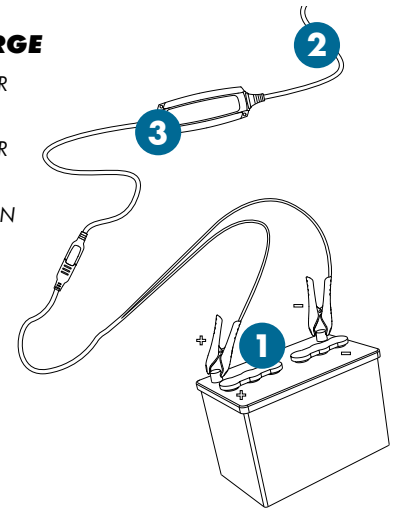

**GUARANTEED QUALITY WITH CTEK**

CTEK customer support is available to answer any questions related to charging and CTEK chargers. Safety, simplicity and flexibility characterizes all products and solutions developed and sold by CTEK. CTEK supply chargers to more than 60 countries throughout the world. CTEK is also a reliable OEM supplier to many of the world's most prestigious car and motorcycle manufacturers.

**Contact customer support: [info@ctek.com](mailto:info@ctek.com)**